

INSULATION

Polyesterimide Enamelled Round Aluminium Wire, Class 180

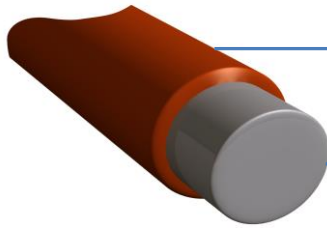

→ Base Coat: Theic Modified Polyesterimide

→ Conductor: Aluminium

STANDARDS

| | |
|------|------------------|
| IEC | 60317 - 15 |
| NEMA | MW 30 - A |
| TSE | TS EN 60317 - 15 |

AVAILABILITY

0,300 - 5,00 mm.
4 - 28 AWG

APPLICATIONS

Motors, Hermetic Motors
Refrigerant and Compressor Motors
Automotive Alternators
Torroidal Coils
Solenoids
Dry-Type Transformers

PROPERTIES

Suitable for high speed winding.
Excellent dielectric performance
Superior chemical and moisture resistance
Superior thermal overload protection
High mechanical and thermal properties

TECHNICAL PROPERTIES

MECHANICAL

| | | |
|------------------------|-------------------------|--------------------|
| Elongation | d<1,600mm | % >2 x IEC Value |
| | d>1,600mm | % >1,3 x IEC Value |
| Mandrel Test | 1 x Diameter - No Crack | |
| Resistance to Abrasion | >2,5 x IEC Value | |

THERMAL

| | |
|---------------|----------|
| Thermal Index | 180 °C |
| Heat Shock | > 200 °C |
| Cut Through | > 320 °C |

CHEMICAL

| | |
|-------------------------------|------|
| Resistance to Solvents | 4H |
| Resistance to Refrigerants | Good |
| Resistance to Transformer Oil | Good |

ELECTRICAL

| | |
|------------------------------------|------------------|
| Breakdown Voltage | >1,5 x IEC Value |
| Conductivity (m/Ωmm ²) | >35,5 |
| Pinhole | Free |